

490.00 mm

210.00 mm

CCST2001 Series Thermostat User Guide



For Fan Coil Unit

Welcome

Thank you for your purchase.
Your new thermostat will provide uniform and comfortable temperature control throughout every room in your property. We bring together technology, craftsmanship and highest quality materials to provide you with a safe, reliable product combined with sleek, contemporary design.
Please read this installation/programming manual for comprehensive instructions on installing and operating your thermostat. Please also ensure a suitably qualified person installs your thermostat and complies with all local regulations.

In the box you will find

Thermostat	1pc	Screws	2pc
User Guide	1pc		

ABOUT YOUR THERMOSTATS

1000 series Modern Round Touch Screen Room Thermostats are designed to on/off control the fans and valves in air conditioner applications via comparison of the room temperature and setting temp., as reaching the aim of comfort and saving energy.

MODEL DEFINITION

A : Two pipe; Control Fan Coil Unit and Two Wired Motorized Valve
M : Two pipe; Control Fan Coil Unit and 0-10V Motorized Valve
E : Four pipe; Control Fan Coil Unit and Two Wired Heat Valve and Two Wired Cool Valve.
N : Modbus RTU communication
K : Wi-Fi connection
W2 : Window
E : External Sensor
For example: 1000ALW

FEATURES

On Appearance

1. 86mm hidden box and European 60mm round box is suitable.
2. White, black or gold housing creates your colorful life.
3. White backlight protect your eyes
4. Touch buttons to make simple operation.
5. Amazing Silver Frame opens your modern life.

On Functionality

1. Powerful functions are available such as Modbus/WIFI etc.,
2. 0.5°C Accuracy keeps temperature within the level you set.
3. Data memory when power is off.
4. 5+2 six periods programmable maximize comfort and economy.
5. Create thermostat group to centrally control.
6. Integrated with *Amazon Echo*, *Google Home*, *Tmall Genie*, *IFTTT*.
7. Support Device Sharing.
8. All setting languages synchronize your time zone, address and language
9. No limit to add room.
10. Support Smart Scene.

DIMENSION

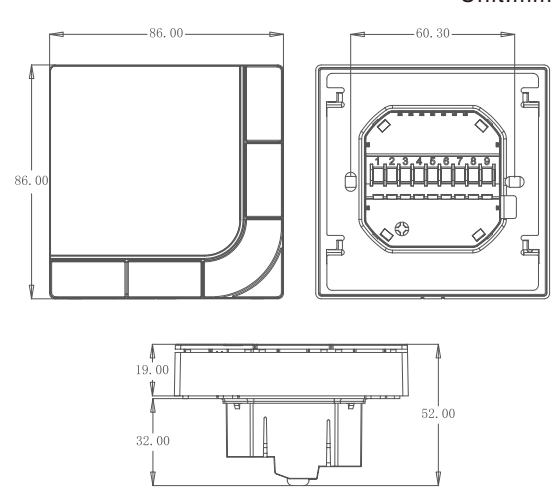

TECHNICAL DATA

Power Supply: 95 ~ 240 VAC, 50 ~ 60HZ
Fan Relay Amps Resistance: 5A; Inductive: 3A
Valve Relay Amps Resistance: 3A; Inductive: 1A
Sensor: NTC3950, 10K
Accuracy: ±0.5 °C
Set Temp. Range: 5 ~ 35 °C
Display Temp. Range: 5 ~ 99 °C
Ambient Temp.: 0 ~ 45 °C
Ambient Humidity: 5 ~ 95 % RH (Non Condensing)
Storage Temp.: -5 ~ 45 °C
Power Consumption: <1.5W
Timing Error: <1%
Shell Material: PC+ABS (Fireproof)
Installation Box: 86 * 86mm Square or European 60mm Round Box
Wire Terminals: Wire 2 x 1.5 mm² or 1 x 2.5 mm²
Protection Class: IP20
Buttons: Tact Switch Buttons

BEFORE WIRING AND INSTALLING...

1. Read these instructions carefully. Failure to follow them could damage the product or cause a hazardous condition.
2. Check the ratings given in the instructions and on the product to make sure the product is suitable for your application,
3. Installer must be a trained, experienced service technician.
4. After installation is complete, check out product operation as provided in these instructions.

CAUTION

Electrical Shock or Equipment Damage Hazard. Can shock individuals or short equipment circuitry.
Disconnect power supply before installation.

WIRING

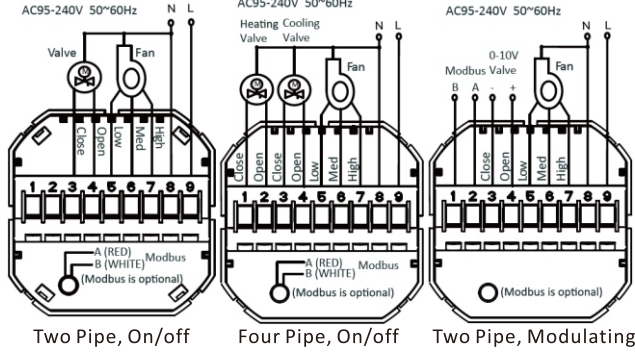

INSTALLATION

Your thermostat is suitable for installation within a standard 86mm patterns box or European 60mm patterns box.
Step 1. Keep the electricity off. See Fig 1.
Step 2. Remove the mounting Plate by rotating the LCD part. See Fig 2.

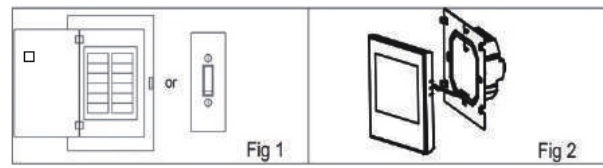

Step 3. Connect power supply, load into the appropriate terminals. (see "Wiring your thermostat" for details and Fig 3)
Step 4. Fix the mounting plate into the wall with screws in the box. See Fig 4.

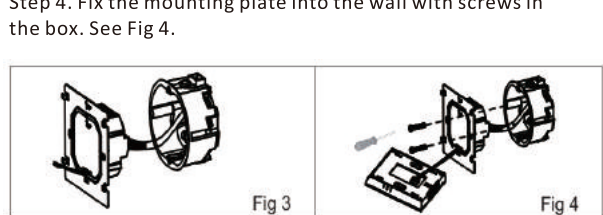

Step 5. Fasten body of thermostat and the mounting plate See Fig 5
Step 6. Installation complete. See Fig 6

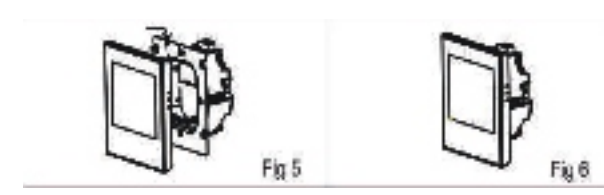

HOME SCREEN QUICK REFERENCE

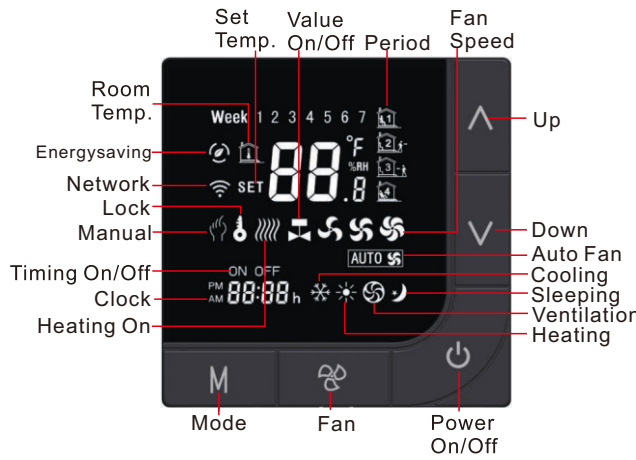

OPERATION

During Power On

1. **Power On/off:** Press **⏻** to turn the thermostat on/off.
2. **Manual & Programmable**
Press and hold **M**, **🔒** will flash. Press **A** to select manual and press **⏻** to select weekly programmable.
3. **Setting Temperature**
In the mode of manual, press **A** **↕** to set temperature. **⏻** will display.
4. **Locking Your Thermostat**
Press and hold the **A** **↕** for 5 seconds to lock/unlock your thermostat. In item 3 of high senior options, you can select full lock or half lock.
5. **Selecting System Mode**
Press **M** to change the system mode HEATING, COOLING and VENTILATION. In the mode of VENTILATION, the valve is off but the fan runs.
6. **Setting the Fan Speed**
Press **🌀** to select the fan speed AUTO, HIGH, MED, LOW.
7. **Adjusting/Setting the Clock**
Press and hold **M**, **🕒** will flash. Press **M** to set minute, hour and weekday (1 = Monday, 2 = Tuesday etc.) by using the **A** **↕** arrows, after 3 seconds the value will be confirmed automatically.

8. Adjusting the Weekly Programmable

Press **M** to do the adjustment of weekly programmable. Then press **M** to change the different items. Press **A** or **↕** to set the relative values.
Your thermostat provides six scheduled heating and cooling periods each day — three Comfort periods - 1, 3 & 5 (the temperature required when room is occupied) and three Economy periods — 2, 4 & 6 (the temperature required when room is unoccupied). You can set both the time and temperature for each of these six daily periods. Adjusting/setting the schedules can only be carried out when in program mode; Touch **M**(mode) to change between manual mode and program mode.

In manual mode, **🕒** will show in the bottom left of the screen. Touch the icon **M** for four times until the weekday schedule settings appear (12345 will show along the top of the screen).
Use the **A** and **↕** arrows to adjust the time for the 1st (Comfort) period. Press the icon **M** and use the **A** and **↕** arrows to set the temp. for the 1st period. Repeat this process for periods 2 — 6.
Press the icon **M** once more to enter the weekend schedule settings (6 & 7 will show along the top of the screen). Repeat the above process to set the weekend schedule. Press **M** once more to confirm and exit.

Default settings for program schedule

Time display	WEEKDAY (MONDAY ~ FRIDAY) (1,2,3,4,5 shows on screen)		WEEKEND (SATURDAY) (6 shows on screen)		WEEKEND (SUNDAY) (7 shows on screen)	
	TIME	TEMPERATURE	TIME	TEMPERATURE	TIME	TEMPERATURE
Period 1	06:00	20°C	06:00	20°C	06:00	20°C
Period 2	08:00	15°C	08:00	20°C	08:00	20°C
Period 3	11:30	15°C	11:30	20°C	11:30	20°C
Period 4	13:30	15°C	13:30	20°C	13:30	20°C
Period 5	17:00	22°C	17:00	20°C	17:00	20°C
Period 6	22:00	15°C	22:00	15°C	22:00	15°C

In the mode of programmable, set temp., time could not be adjusted.

During Power Off

Setting the Functions and Options

When power is off, press and hold **M** and **🌀** at the same time for 5 sec. in order to reach system function.
Then press **M** to change the different items.
All the settings will confirm automatically when power is on.

Code	Function	Setting and options	Default
1	Temperature Compensation	-7 to 7 °C	-1
2	Fan control	00: When room temp. reaches the set point, the fan will turn off 01: When room temp. reaches the set point, the fan will turn to low speed	0
3	Button Locking	00: All buttons are locked except power button 01: All buttons are locked	01
4	Heat/cool	00: Cool only 01: Heat/Cool	01
5	Min. Set Temp.	5 to 15°C	05
6	Max. Set Temp.	5 to 35°C	35
7	12/24 hours	00: 12h 01: 24h	01
8	Display Mode	00: Display both set temp. and room temp. 01: Display set temp. only	00
9	Eco Mode	00: Non-energy saving 01: Energy saving, set temp. keep eco Temp.	00
A	Heating Eco Temp.	10 to 30°C	20
B	Cooling Eco Temp.	10 to 30°C	26
C	Dead Zone Temp.	1 to 5°C	1

ABOUT Wi-Fi

Wi-Fi CONNECTION

Before using your Wi-Fi thermostat for the first time, you must configure the Wi-Fi signal and settings through your smart phone or tablet. This will allow communication between your connected devices.

Step 1 Download your APP (Fig 1-1)



For iOS devices, search for *Smart Life* in Apple Store and download. Alternatively, scan the relevant QR code here (Fig 1-2).
For Android devices, search for *Smart Life* in Google Play and download. Alternatively, scan the relevant QR code (Fig 1-3).

Step 2 Register your account

Open Smart Life, you will go into a page of register (Fig 2-1). Click **Register**, you will get a piece of notification (Fig 2-2), click **Agree** to go into your page of register (Fig 2-3). Enter your phone no. or email (Fig 2-3) then you can get a verification code. Input your verification and confirm (Fig 2-4) to complete your registration. If you have account, please log in.

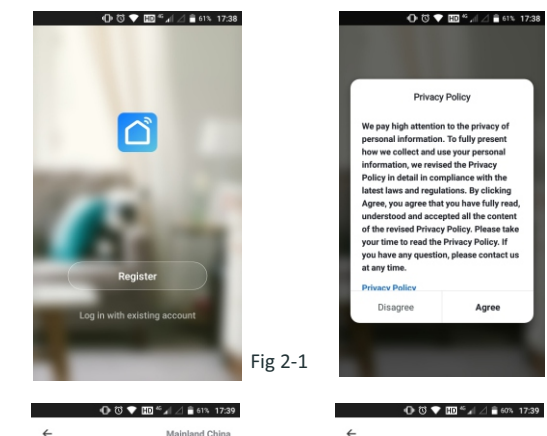

Step 3 Connect your Wi-Fi signal

On your thermostat

With power off, press and hold the **↕** arrow for eight (8) seconds. The back light will be on and the icon **🔒** will flash one time per second. Then, go back to the home page of your app
If it's your first time to log in, you need to creating a family first. After that, you will go into the home page of the APP (Fig 3-1). Click + on the upper right corner of the page (see Fig 3-1), Then locate the thermostat and add it.

Click **Confirm indicator rapidly blink** (Fig 3-2) then select your network and enter the Wi-Fi password (Fig 3-3). This may typically take up to 5~90 seconds to complete (Fig 3-6). All your family, room and device name could be edited when the device is connected.

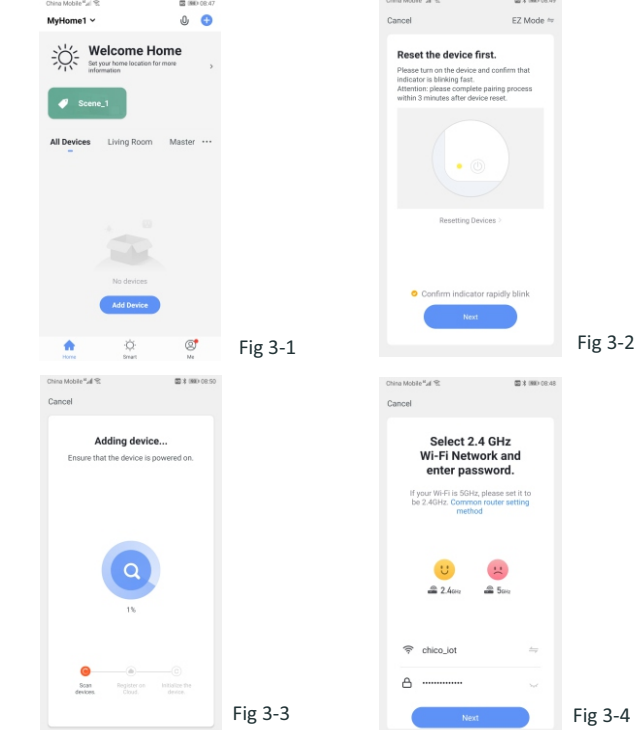

This is EZ mode which provides fast network connection between your app and your device. If your router doesn't support it or your Wi-Fi signal is weak or you can not connect by EZ mode, press the **AP Mode** on the upper right corner in Fig 3-2.

If you have connected your thermostat successfully, please ignore the AP setting as below.

On your thermostat

With power off, press and hold the **↕** arrow for eight (8) seconds. The back light will be on and the icon **🔒** will flash one time per sec.. With power off, Press **M** and **↕** buttons and hold them for eight (8) seconds until **🕒** indicating 2s/time.

Then, go back to the home page of your app

Go into add device page, selected AP mode (Fig 4-1), click Confirm indicator slowly blink (Fig 4-2) then selected your network and enter the password of your wireless router (Fig 3-4) and confirm. The app will go into the page in Fig 4-3.

Press **Go to Connect** to select the Wi-Fi signal Smartlife-XXXX of your thermostat (Fig 4-4).

When the Smartlife-XXXX was connected (Fig 4-4), go back to your app and the app will connecting your device automatically (Fig 3-3). This may typically take up to 5~90 seconds to complete.
Your room and device name could be edited when the device is connected.

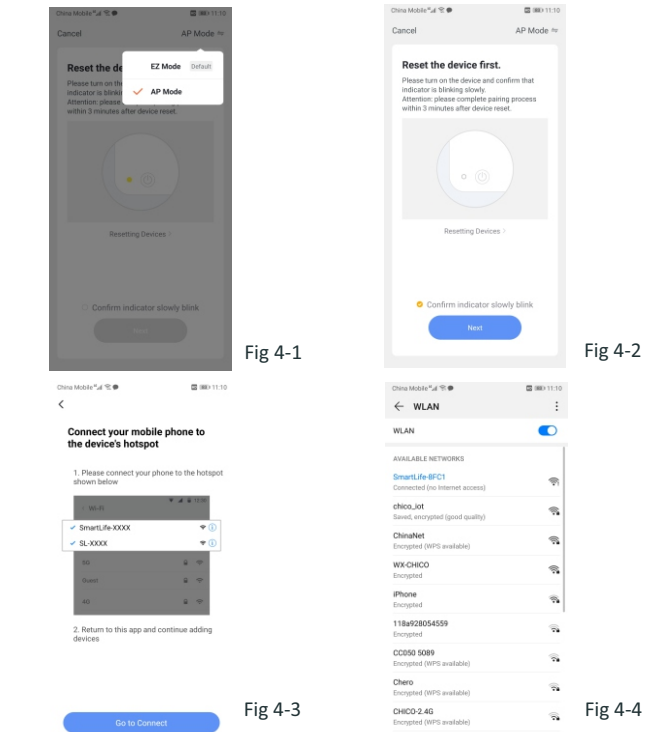

PROGRAMMING YOUR THERMOSTAT

When your room is established successfully, it will display on the home page. The round button is to turn on/off your room. Click the line into begin programming your thermostat.

🔒 / **⏻** Power on/off button. When the screen is bright, it is power on; when the screen is dark, it is power off.

🔒 / **🌀** Mode button. In this mode you can set cooling, heating and ventilation. **🔒** is heating, **🌀** is cooling and **🔒** is ventilation.

🌀 Fan Speed button. Press this button to select auto, low, med and high speed (Fig 5-4).

🔒 Setting button. Press this button to operating Child lock, ECO mode and Manual/Programmable mode select (Fig 5-2).

🕒 Week Program button. When this button is pressed, your will go into a "5+1+1" schedule (Fig 5-3), Where you can simply click on the working days (Mon-Fri) and then the time/Temp. to adjust to your preferred schedule.

↕ / **↕** Up/Down button. You can up/down the Set Temp. by pressing these two buttons.

Tips about week program:

* You can set 6 periods - time and temp. (see Fig 5-3).

* Once your schedule has been set, click on **Save** and the app will send the programming to your thermostat and confirm the schedule has been saved.

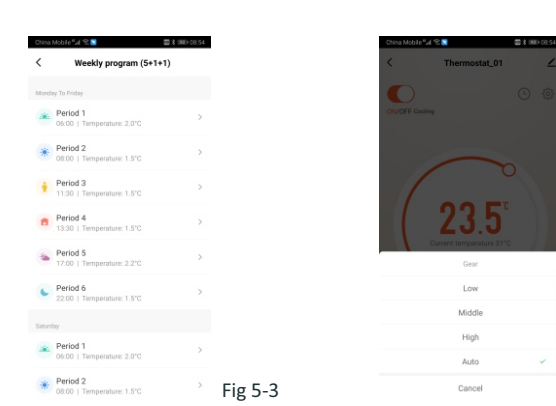
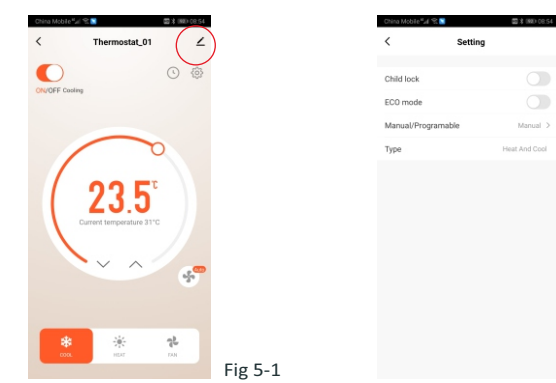

How to create a group?

Press the edit button in the red circle (Fig 5-1) then click Create Group (Fig 6-1). Select all the rooms you want and confirm.

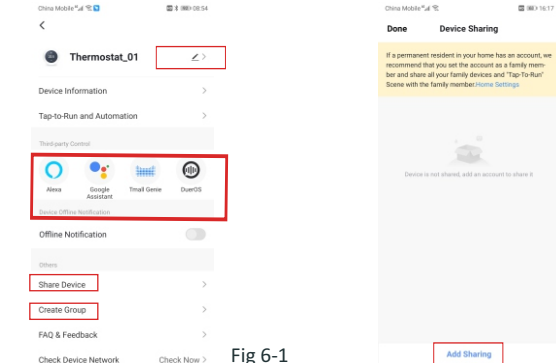

The one who create this group can control all the rooms at the same time.

Note:

Except create the group, in this menu page, you can also modify your device name, share your device, get the information of your device.

How to share your device with your family member?

Way 1: Mentioned in the above.
Way 2: Click Share Device in page Fig 6-1, then add the account you want to share.

You can see the sharing account you have sent and the device you have shared in the page.

You don't need to do anything if you are the one shared.

You can add as many as rooms you want

How to connect your device to Amazon Echo or Google Home?

In page Fig 6-1, select Supported Third-Part Control.

Click one of them Amazon Echo or Google Home or IFTTT or Tmall Genie/then you can see the operation steps.

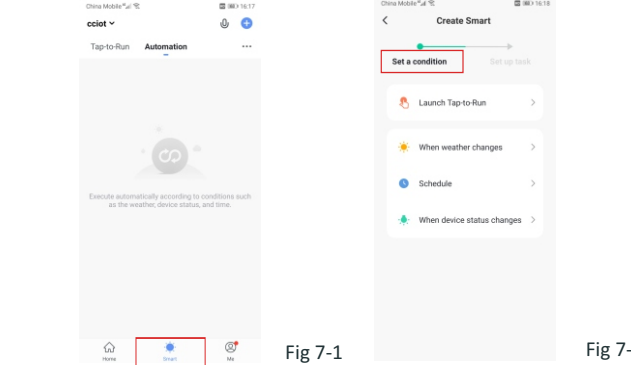

What is your Smart Scene and How to use it ?

Customize your own personal scenes to suit your needs. For example, set your home to automatically turn on thermostat on when you back home. In **home** page, click Smart at the bottom of the page, then you will go into a page of smart scene (Fig 7-1). Now, select the Automation and click + on the upper right corner of the page to into the setting page (Fig 7-2)
Step 1: You can select condition to perform task, just like temperature, humidity, Weather, PM2.5, air quality etc.

Step 2: Add actions that you want to carry out. For example, execute a scene, send a reminder, or Timing on / off, switching mode, locking / unlocking your devices.

Step 3: Set up a task.

Step 4: Save the smart scene.

NOTE: The room sound could be turned on/off in PROFILE-SETTING-SOUND. The sound is matched with the default of your system.

SIMPLE EXCEPTION HANDLING

No	Phenomenons	Handling
1	Power is on but without display.	* Check if the terminals between LCD panel and Power Unit Box is loosen.
2	Power is on but display work.	* Use a new LCD panel or new Power Unit Box to replace the old one.
3	Room Temp. is a little different from the actual.	* Do temperature calibration in item 1 of high senior options

SERVICE

Your thermostat carries an 24 months warranty from date of purchase. Service outwith the warranty period may incur a charge. More detail please contact with us directly.

要求:
1、双面铜版纸, 弹簧折。
2、彩印, 文本、图案清晰, 无明显色差。
3、蓝色 线为折线。